

PORTAVALIGIA SPECIFICO - SPECIFIC CASE HOLDER
 PORTE-VALISE SPECIFIQUE - SPEZIFISCHER KOFFER-TRÄGER
 PORTA-EQUIPAJE ESPECIFICO

PIAGGIO X9 125/180/250

2000/2002

ISTRUZIONI DI MONTAGGIO - MOUNTING INSTRUCTIONS
 INSTRUCTIONS DE MONTAGE - BAUANLEITUNG - INSTRUCCIONES DE MONTAJE

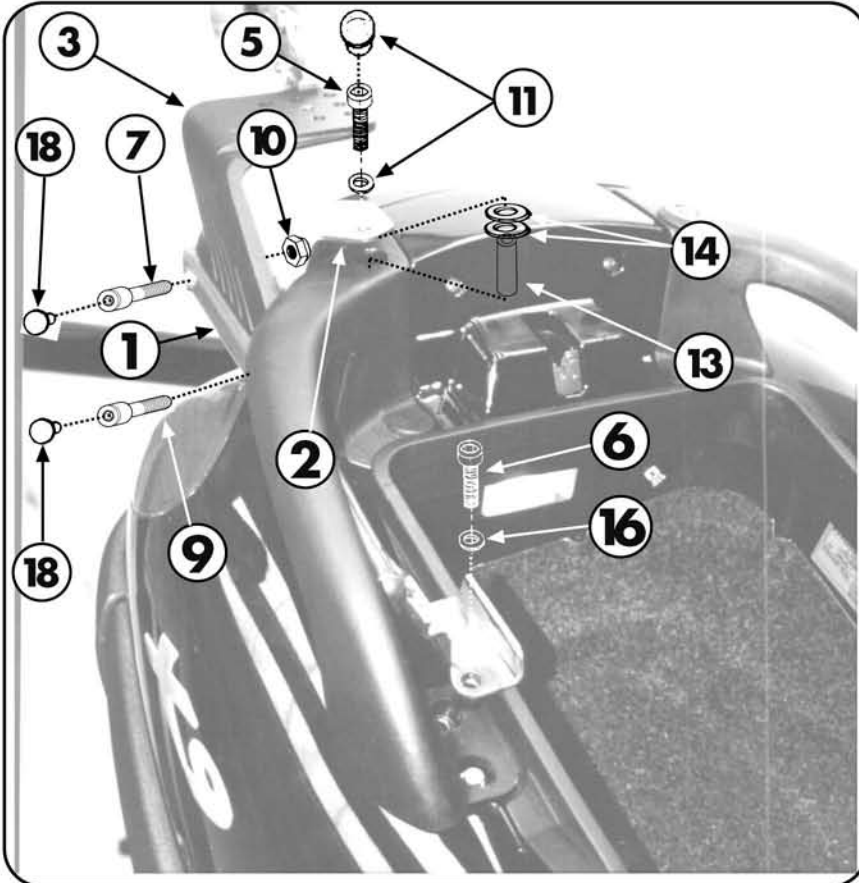

1

MONORACK
 Q.TY n.2 (dx-sx)

2

SUPPORTO LATERALE
 REAR SUPPORT
 SUPPORT LATERAL
 Q.TY n.2 (dx-sx)

3

ALETTA WINGRACK
 WINGRACK FINS
 AILETTE WINGRACK
 Q.TY n.2 (dx-sx)

4

PIASTRA Z255
 Z255 PLATE
 PLATINE Z255
 Q.TY n.1

5

VITE TCEI 6 X 115
 SCREW M 6 X 115
 VIS M 6 X 115
 Q.TY n.2

6

VITE TCEI 6 X 50
 SCREW M 6 X 50
 VIS M 6 X 50
 Q.TY n.2

7

VITE TCEI 8 X 25
 SCREW M 8 X 25
 VIS M 8 X 25
 Q.TY n.2

8

VITE TCEI 8 X 30
 SCREW M 8 X 30
 VIS M 8 X 30
 Q.TY n.2

9

VITE TCEI 8 X 35
 SCREW M 8 X 35
 VIS M 8 X 35
 Q.TY n.2

10

DADO A.B. M8
 BOLT M8
 ECROU M8
 Q.TY n.6

11

COPRIVITE
 SCREW CAP
 CACHE VIS
 Q.TY n.2 (a+b)

12

RONDELLA Ø 8
 WASHER Ø 8
 RONDELLE Ø 8
 Q.TY n.4

13

DISTANZIALE
 13 X 71 Ø 6,5
 COLLAR DISTANCE
 COLLIER DE
 SEPARATION
 Q.TY n.2

14

RONDELLA GOMMA
 RUBBER WASHER
 RONDELLE EN
 CAOUTCHOUC
 Q.TY n.4

15

COPRIASOLA
 OVAL CAP
 CACHE OVAL
 Q.TY n.2

16

RONDELLA Ø 6
 WASHER Ø 6
 RONDELLE Ø 6
 Q.TY n.2

17

PIASTRINA GN867
 LITTLE PLATE
 PLAQUETTE
 Q.TY n.2

18

COPRIVITE
 SCREW CAP
 CACHE VIS
 Q.TY n.4

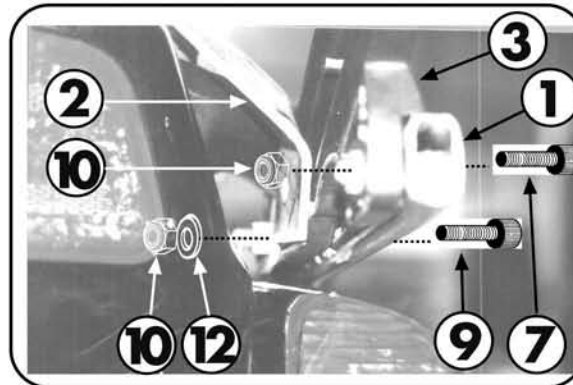

VISTA INTERNA MONTAGGIO SUPPORTO ED ALETTA POSTERIORI (pz.2 e 3)

INSIDE VIEW OF MOUNTING OF BACK SUPPORT AND FINN (pcs. 2 and 3)

VUE INTERIEURE DU MONTAGE SUPPORT ET AILETTE POSTERIEURES (pcs. 2 et 3)

